



# BUILDING OUR FUTURE

## STAYING THE COURSE



Livingston Board of Education  
November 20, 2006

# BUILDING OUR FUTURE Staying the Course

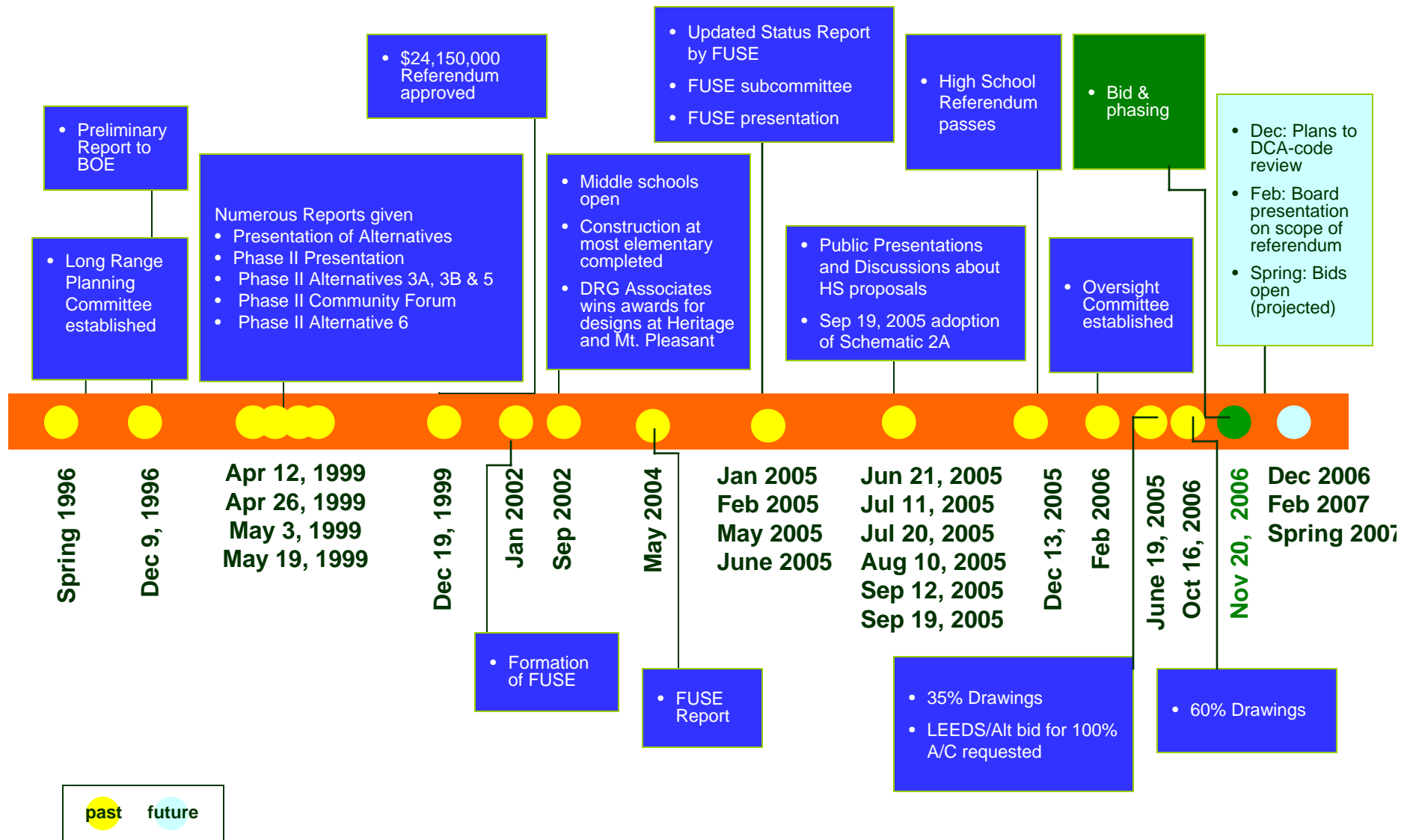



May 2005: FUSE Presentation

Three potential schematics  
presented to Board and  
public

# May 2005: Schematic 1

\$42 million plus land (\$800,000 per acre)

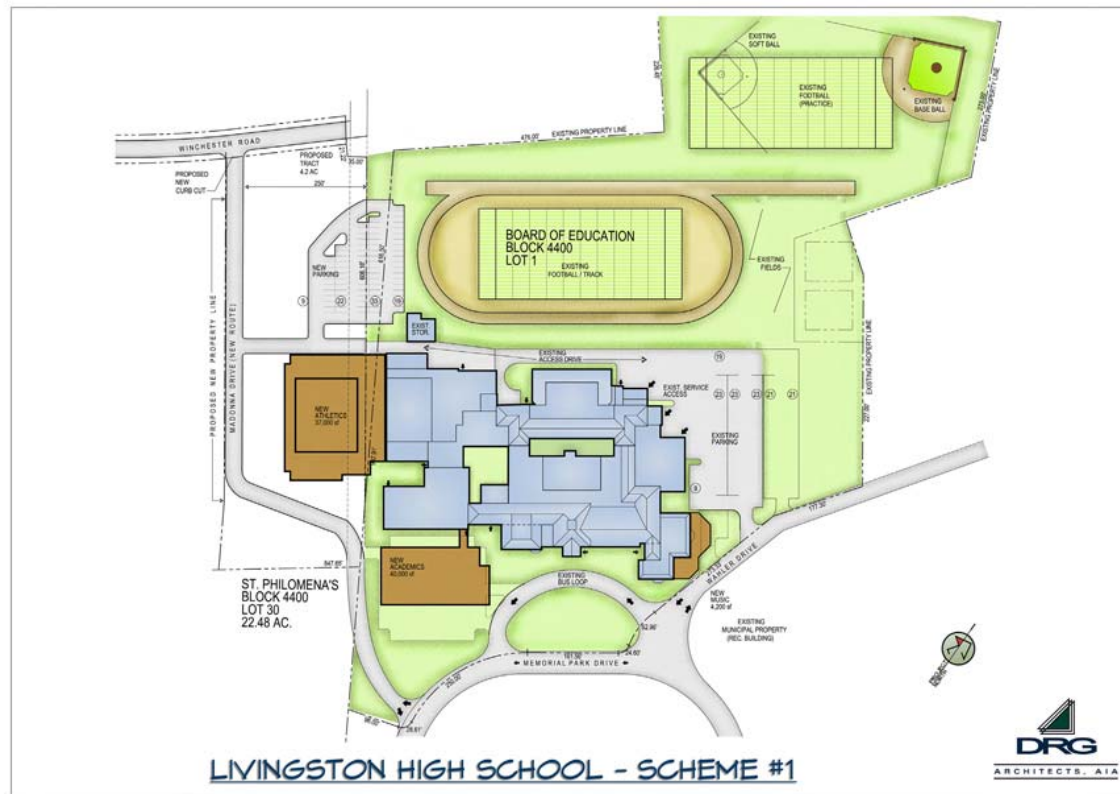

# May 2005: Schematic 2

\$36 million (no land cost)



# May 2005: Schematic 3

- \$32 million (no land cost)

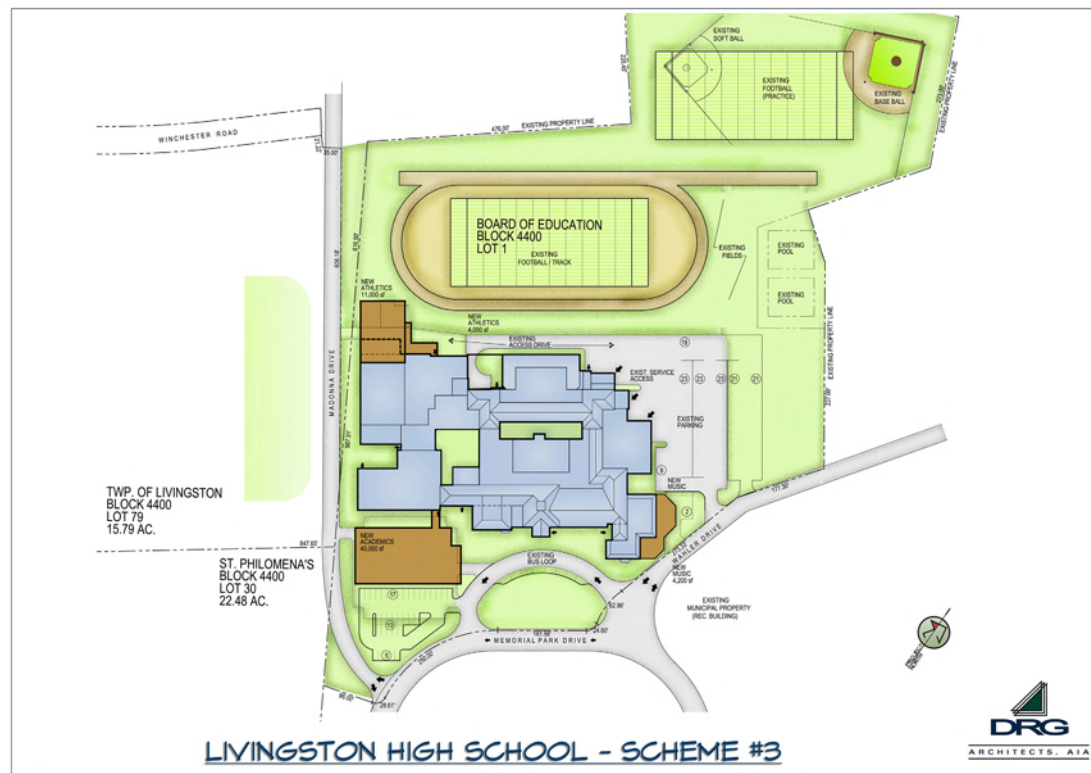

# June 2005: FUSE Report to Board

- Presents fourth schematic
- \$48 million

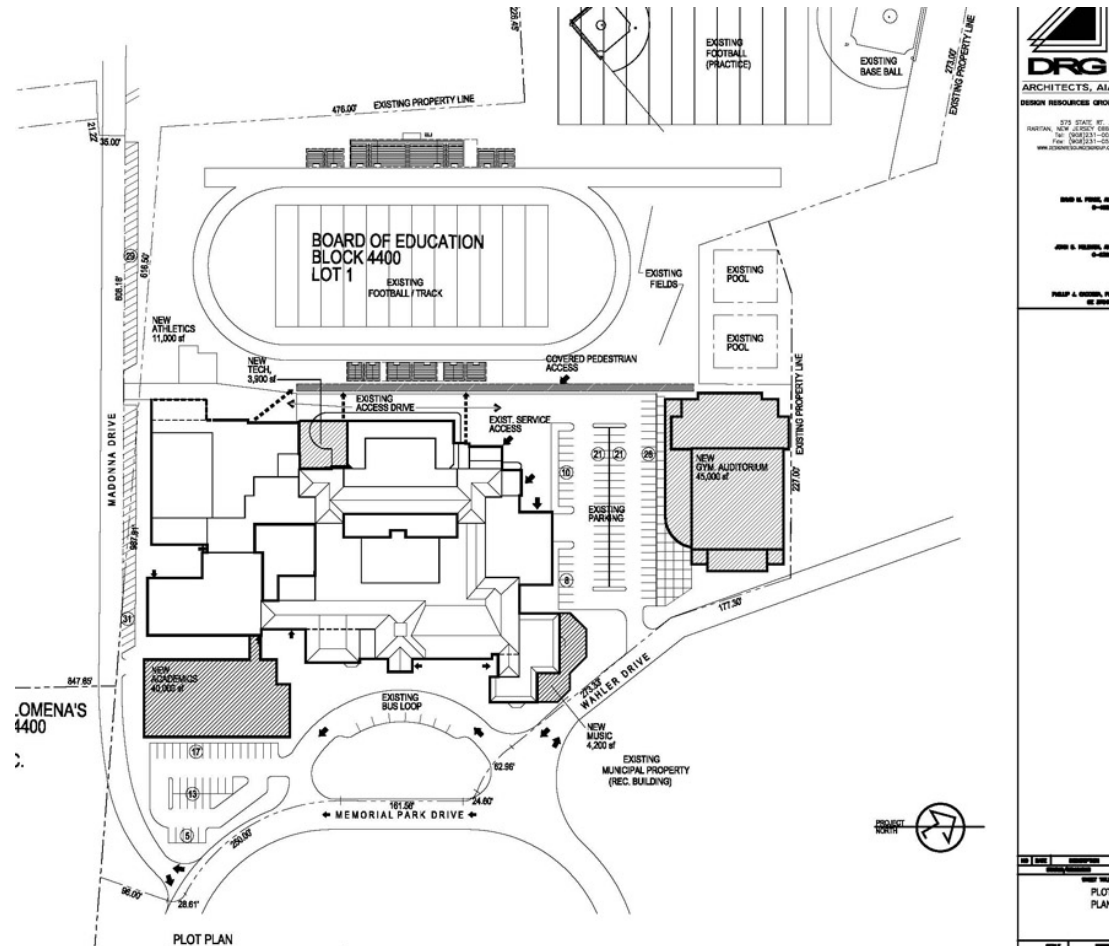



# Public Presentations/Discussions About Proposals

- June 21, 2005
- July 11, 2005
- July 20, 2005
- August 10, 2005
- September 12, 2005
- September 19, 2005



# September 19, 2005: Adoption of Schematic 2A

■ \$51.5 million





# DRG Associates and district begin negotiations for fee structure

- No legal requirement for public bid
- Firm had successful history (on time/on budget) with district
- Extensive NJ educational experience
- Fees negotiated well below industry standard
- Industry standard: 6% - 9%
- DRG Associates: 4.8%  
(\$2,495,000/\$51,521,069)

# DRG Awards for Heritage

- 2003 American School & University
  - Architectural Portfolio - Outstanding Buildings: Middle Schools
  - Interior Design Competition – Center Citation: Classroom Interiors
- 2003 School Planning & Management
  - Learning By Design A Lesson in Excellence



# DRG Awards for Mount Pleasant

- 2003 American School & University Interior Design Competition
  - Silver Certificate – Mount Pleasant Elementary School (Media Centers)
- 2002 NJSBA/NJASBO/NSASA Architecture for School Design Competition
  - Third Place – Mount Pleasant Elementary School

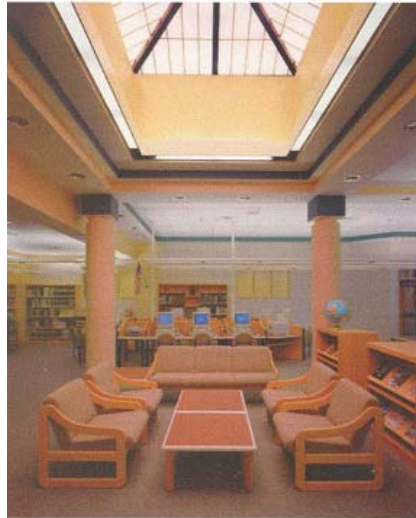



# December 2005

- Referendum Bulletin mailed to all Livingston households included the following:
  - Projected costs of LHS construction/renovation project and how costs were determined
  - Frequently Asked Questions
    - Why is the football field being moved?
    - How many classrooms will we gain?
    - How can overcrowded hallways be dealt with?
    - How long has the plan been worked on?
    - Have there been any alternatives?
    - Are amenities such as a weight room, dance studio and increase in gym size necessary?
    - Has the community been involved?
    - And more
- December 13, 2005: Referendum passes

**LIVINGSTON BOARD OF EDUCATION  
Referendum Bulletin  
December 2005**

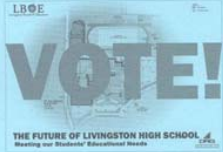

**Tuesday, December 13, 2005  
Polls Open: 1:00 pm – 9:00 pm**

Vote at your regular polling place, shown in the sample ballot you receive from the County

If you don't know where to vote, call the Township at 973 992-5000 or the Board of Education at 973 535-8000 ext 8002

On December 13 voters in Livingston are asked to go the polls to take part in a special election regarding a proposal "... (a) to provide for the construction of additions, renovations and alterations at Livingston High School, including acquisition and installation of furnishings and equipment and site work; (b) to appropriate therefore \$51,521,069, including a \$10,295,683 State grant for which the school district is eligible..."

**Highlights of the Proposed Plan**

- Add approximately 95,000 new square feet to Livingston High School and renovate about 68,000 square feet
- Provide a new science wing with 14 classrooms; an applied technology lab; additional classrooms in every department; a new gymnasium with physical education stations and team rooms; a second TV studio; expanded music rooms and an expanded student cafeteria
- The new gymnasium provides a place to bring the entire LHS community together for activities or security and will be incorporated into the Township Emergency Operating Plan
- Actual construction is estimated to take 18 months beginning June 2007 with completion by January 2009
- Estimated cost: \$51,521,069

**Reasons for the Proposed Referendum**

There has been a 32% increase in student population at Livingston High School since the 1990-1991 school year. By 2008-2009, this increase is estimated to be 44%. By 2013, it is estimated to be 67%. As these enrollment figures show:

- 1990-1991: 1,196 students
- 2000-2001: 1,413 students
- 2003-2004: 1,538 students
- 2004-2005: 1,578 students
- 2008-2009: 1,727 students (anticipated)
- 2013-2014: 2,000 students (anticipated)

1,586 students currently attend Livingston High School, which has a functional capacity (total square feet divided by 151 square feet per student) of 1,413 students. Because of these numbers, room utilization at Livingston High School is at 98%. The State guideline recommendation is 83%.

**Did you know?** Livingston is a comprehensive high school that offers a full range of programs from technical to academic where students of all ability levels are afforded the opportunity to achieve.

**What the Overcrowding Means**

The overcrowded high school results in congested hallways and stairways; larger class sizes; students turned away from courses; limited ability to improve course offerings; the lack of space for instructional technology; lunch periods as early as 10:12 am and as late as 1:52 pm; lack of meeting spaces; lack of athletic and physical education facilities; lack of space for testing; lack of parking space and inadequate storage. For example:

- Algebra 2 sections were closed due to space constraints, and some math classes have 31 students. The referendum would increase the number of mathematics classrooms, as well as the number of English and social studies classrooms, from 10 to 12. The science department, which has a number of older, small rooms, including two without water and lab tables, will gain 14 new state of the art rooms. The existing 12 science classrooms will be renovated and used for other subjects.
- Present facilities do not accommodate the number of students requesting TV Production and Digital Imaging courses; between 40 and 60 students per year are closed out and freshmen and seniors are barred from Basic TV. The proposal will provide two additional classroom spaces and an additional TV studio.
- The State mandates that students take physical education each year of their high school experience. Currently there are 30-40 students per gym class; the optimal size for learning and safety is 24. The new gym would increase the number of physical education stations from five to eight, thus freeing the auxiliary gym for the two TV studios and two digital imaging classrooms described above.



# Thanks to the members of the Long Range Planning Committee

Martha Ackermann  
Sandy Berenhaus  
Cindy Blustein  
Margret Bonito  
Anthony Calcado  
Barbara Chekijian  
Anita Codey  
Dr. Anthony Del Tufo  
Karen Garber  
Sheila Goldklang

Nina Goldman  
Joyce Gore  
Stan Graboski  
Robert Grady  
Gary Greenstein  
Eunice Grippaldi  
John Hopton  
Christine Jung  
Dr. Margaret Kantes  
Doree Kesselbrenner

Len Merlo  
Dr. David Montroni  
Lance Phillips  
Chitra Radin  
Steve Robinson  
Susan Rothbard  
Dr. Bernard Searle  
Dr. James Sheerin  
Carol Sumner  
Diane Zambito

# BUILDING OUR FUTURE Staying the Course

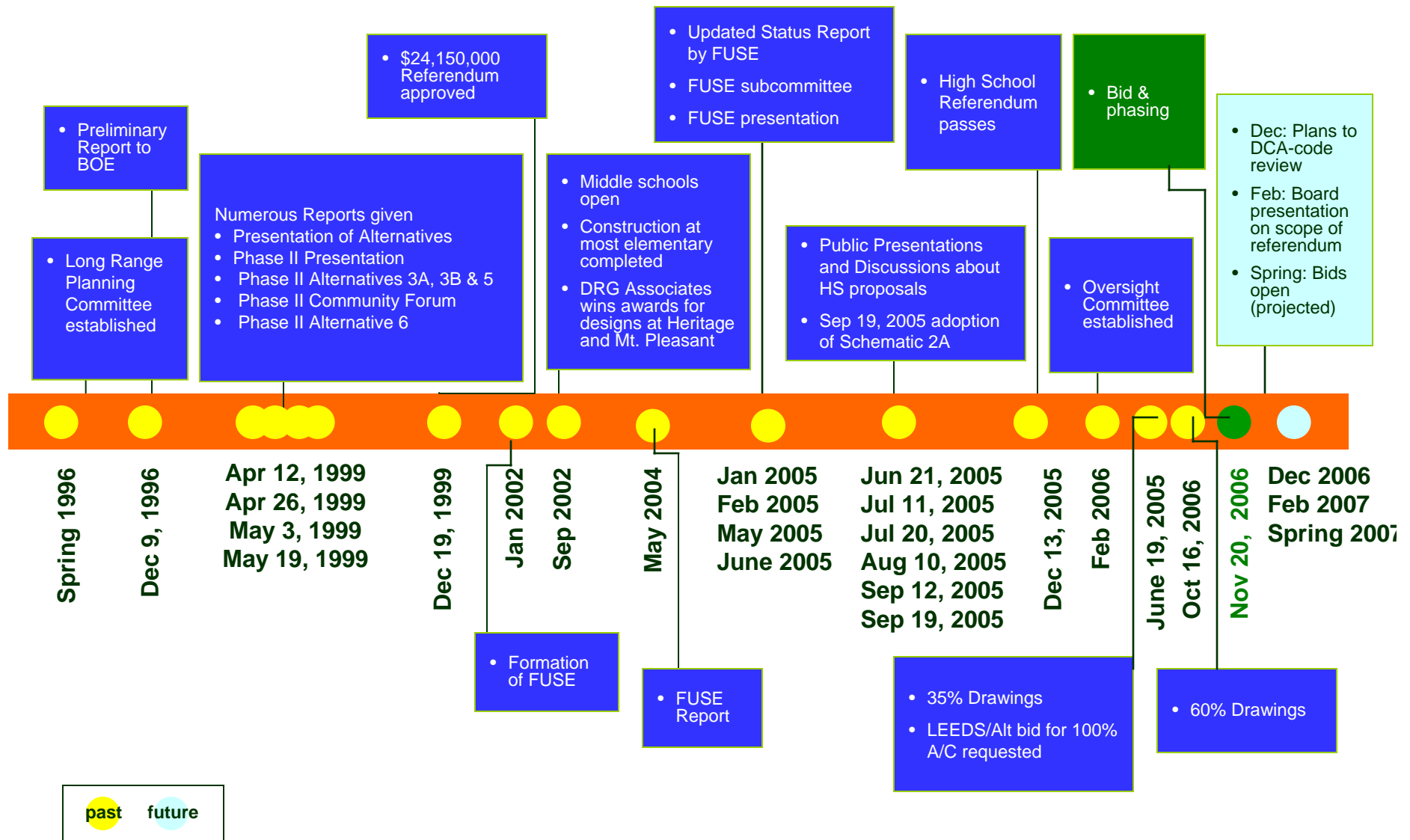



# Thanks to the FUSE Members

Rich Banagan

Tony Calcado

Warren Curd

Dr. Anthony Del Tufo

Helen Derot

Nancy Elmezzi

Rebecca Emert

Michele Feingold

Paul Fried

Elliot Friedman

Frank Fontana

Pat Genova

Sheri Goldberg

Scott Goldman

Robert Grady

Bonnie Granatir

Eunice Grippaldi

Betty Guglielmino

David Hyman

Chris Jung

Doree Kesselbrenner

Tom Kietrys

Paul Ko

Diane Koza

Andy Krupa

Kathy Malanga

Len Merlo

Jamie Mirsky

Dr. Mark Mongon

James Novotny

Lori Perez

Lance Phillips

Steffi Poss

Mark Quiles

Liz Sanchez

Steve Santola

Scott Schroeder

Dr. Bernard Searle

Patrick Seiwel

Charles Tahaney

Emile Talarico

Jerry Walker